

CARLIG SIMPLU MODEL 140 DIN 15401/1 UNI 9469/1

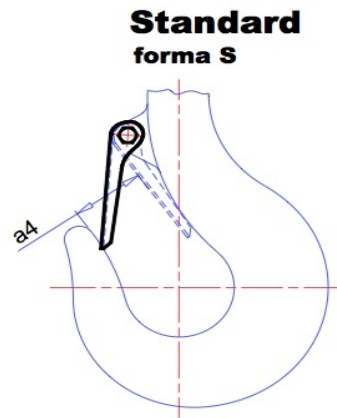

COD		MARIME	DIMENSIUNI													Greutate kg
CLASA P	CLASA V		a1 mm	a2 mm	a3 mm	a4 mm	b1 mm	b2 mm	d1 mm	h1 mm	h2 mm	l0 mm	l1 mm	l2 mm		
139 112 PS	139 112 VS	012	30	24	34	20	19	15	16	22	19	108	-	-	0,45	
139 125 PS	139 125 VS	025	36	28	41	24	22	19	20	28	24	125	-	-	0,70	
139 150 PS	-	05	43	34	49	30	29	24	24	37	31	152	-	-	1,50	
140 000 PS	140 000 VS	1	50	40	57	35	38	32	30	48	40	-	197	-	3,00	
140 001 PS	140 001 VS	1,6	56	45	64	38	45	38	36	55	48	-	224	-	4,00	
140 002 PS	140 002 VS	2,5	63	50	72	43	53	45	42	67	58	-	253	-	7,00	
140 004 PS	140 004 VS	4	71	56	80	48	63	53	48	80	67	-	285	-	10,00	
140 005 PS	140 005 VS	5	80	63	90	56	71	60	53	90	75	-	318	-	12,50	
140 405 PS	140 405 VS												-	366	15,00	
140 006 PS	140 006 VS	6	90	71	101	62	80	67	60	100	85	-	380	-	18,00	
140 406 PS	140 406 VS												-	525	23,50	
140 008 PS	140 008 VS	8	100	80	113	71	90	75	67	112	95	-	418	-	31,00	
140 408 PS	140 408 VS												-	580	37,00	
140 010 PS	140 010 VS	10	112	90	127	81	100	85	75	125	106	-	452	-	39,00	
140 410 PS	140 410 VS												-	652	50,00	
140 012 PS	140 012 VS	12	125	100	143	90	112	95	85	140	118	-	510	-	54,00	
140 412 PS	140 412 VS												-	710	69,00	
140 016 PS	140 016 VS	16	140	112	160	100	125	106	95	160	132	-	582	-	82,00	
140 416 PS	140 416 VS												-	782	92,00	

CARLIG SIMPLU MODEL 140 DIN 15401/1 UNI 9469/1

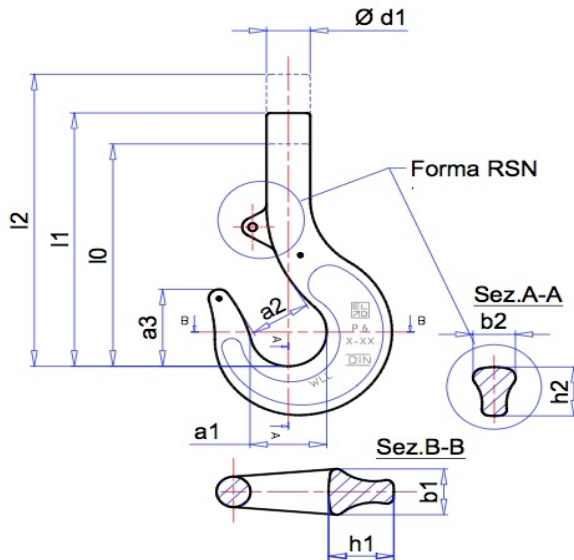
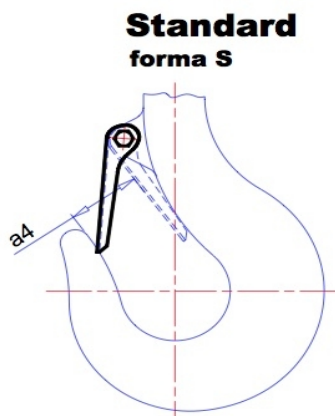
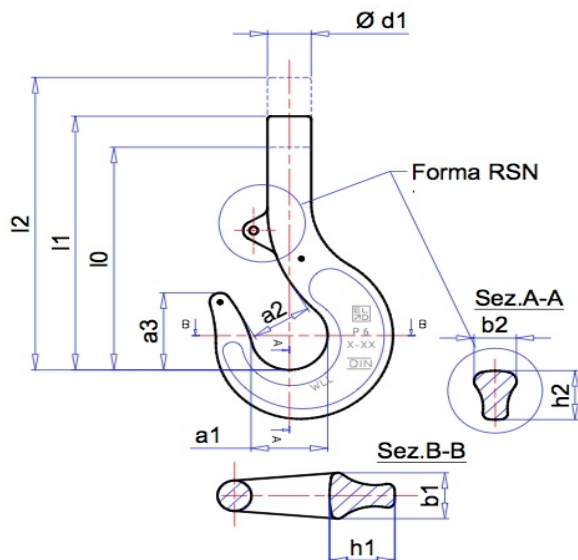

COD		MARIME	DIMENSIUNI											Greutate kg
CLASA P	CLASA V		a1 mm	a2 mm	a3 mm	a4 mm	b1 mm	b2 mm	d1 mm	h1 mm	h2 mm	l1 mm	l2 mm	
140 020 PS	140 020 VS	20	160	125	180	110	140	118	106	180	150	653	-	110
140 420 PS	140 420 VS		-	853	123									
140 025 PS	140 025 VS	25	180	140	202	125	160	132	118	200	170	724	-	157
140 425 PS	140 425 VS		-	924	174									
140 032 PS	140 032 VS	32	200	160	225	145	180	150	132	224	190	796	-	215
140 432 PS	140 432 VS		-	996	236									
140 040 PS	140 040 VS	40	224	180	252	166	200	170	150	250	212	893	-	310
140 440 PS	140 440 VS		-	1093	340									
140 050 PS	140 050 VS	50	250	200	285	185	224	190	170	280	236	990	-	430
140 450 PS	140 450 VS		-	1190	470									
140 063 PS	140 063 VS	63	280	224	320	208	250	212	190	315	265	1120	-	600
140 463 PS	140 463 VS		-	1320	650									
140 080 PS	140 080 VS	80	315	250	358	232	280	236	212	355	300	1270	-	860
140 480 PS	140 480 VS		-	1470	920									
140 098 PS	140 098 VS	100	355	280	402	260	315	265	236	400	335	1415	-	1220
140 498 PS	140 498 VS		-	1615	1290									
140 099 PS	140 099 VS	125	400	315	450	292	355	300	265	450	375	1590	-	1740
140 499 PS	140 499 VS		-	1790	1830									

Alegerea capacității de încărcare în funcție de UNI9465- DIN15400

Dimensiunea "Y" si tipuri de sigurante

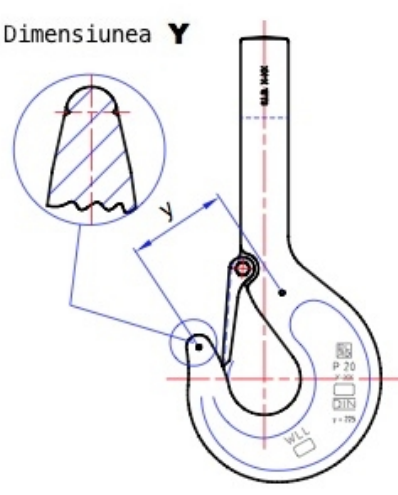
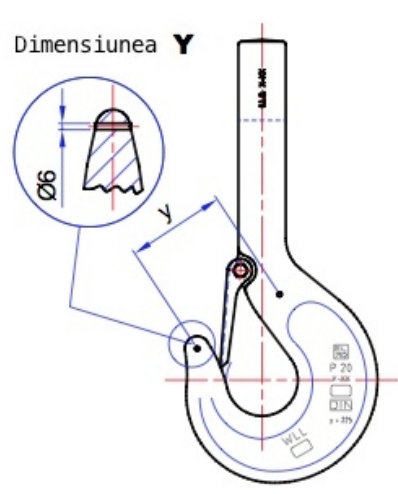
MARIME	y1/y2 mm	Optiuni <i>CARLIG SIMPLU</i> <i>DIN 15401/1 UNI 9469/1</i>	COD (1)		Lungime
			Clasa P	Clasa V	
		Dimensiunea Y si siguranta de blocare standard			
6	130		140 6xx PS	140 6xxVS	I1
8	145				
10	160		140 7xx PS	140 7xxVS	I2
12	180				
16	200	Dimensiunea Y cu stift si siguranta de blocare standard			
20	225		140 2xx PS	140 2xxVS	I1
25	225				
32	290		140 3xx PS	140 3xxVS	I2
40	320				

(1) Inlocuiti literele xx cu urmatoarele valori 06,08,10,12,16,20,25,32, 40,50,63,80,98,99.